

NAME:.....INDEX .....DATE.....

SCHOOL:.....SIGNATURE.....

443 /2  
AGRICULTURE  
Paper 2  
July / August 2010  
Time: 2 hours

## KISUMU NORTH AND EAST DISTRICTS JOINT TEST Kenya Certificate of Secondary Education (K.C.S.E)

### INSTRUCTIONS TO CANDIDATES:

- ❖ Write your name, index numbers and the name of your school in the spaces provided above.
- ❖ This paper consists of three sections A, B and C.
- ❖ Answer all questions in section A and B and answer any two in section C.

FOR EXAMINERS USE ONLY			
Section	Question	Maximum score	Candidates score
A	1-19	30	
B	20-23	20	
C		20	
		20	
	<b>TOTAL</b>	<b>90</b>	

### SECTION A (30MARKS) Answer ALL QUESTIONS.

1. a) What is a zero grazing unit. (½mrk)

.....  
.....

b) If a dairy cow is noticed to be showing first signs of heat at 6.00am. What time should it be inseminated. (½mrk)

.....  
.....

2. Give the difference in appearance between Wessex saddleback and Berkshire breeds of pig. (1mrk)

.....  
.....

3. Name the casual organism of anaplasmosis. (½mrk)

.....  
.....

4. Give three factors that influence digestibility of feeds in livestock. (1½ mrk)

.....  
.....  
.....  
.....

5. State the roles played by the following parts of a combined harvester. (2mrks)

(i) Reel.....

.....  
.....

(ii) Auger.....

.....  
.....

(iii) Front beater .....

.....  
.....

(iv) Threshing drum .....

.....  
.....

6. Name the two diseases which are controlled by one vaccine in livestock.(1mrk)

.....  
.....  
.....

7. Give four structural requirement of good form of store. (2mrks)

.....  
.....  
.....  
.....  
.....

8. State three characteristics of the African wild bee, which makes it better in bee keeping than European bee. (1½mrk)

.....  
.....  
.....  
.....

9. Differentiate between flushing and steaming up in livestock production. (1mrk)

.....  
.....  
.....

10. Give two effects of fleas on host animals. (1mrk)

.....  
.....  
.....

11. Give six advantages of using deep litter system in poultry production. (3mrks)

.....  
.....  
.....  
.....  
.....  
.....  
.....  
.....  
.....  
.....

12. Mention four advantages of embryo transplant in cattle. (2mrks)

.....  
.....  
.....

.....  
.....  
.....

13. Give three sources of water for farm animals. (1½mrks)

.....  
.....  
.....  
.....  
.....

14. State four functions of the lubrication system in a tractor engine. (2mrks)

.....  
.....  
.....  
.....  
.....  
.....  
.....

15. List six causes of sterility in dairy cows. (3mrks)

.....  
.....  
.....  
.....  
.....  
.....  
.....

16. What is the advantage of dehorning by use of dehorning wire. (1mrk)

.....  
.....  
.....

17. a) Under specific feed classes for the following feedstuffs. (1mrk)

- Fish meal .....
- Banana stem .....

b) Name four livestock nutritional diseases. (2mrks)

.....  
.....  
.....  
.....  
.....

18. Apart from high butter fat which other good qualities is jersey breed having over other exotic dairy breeds. (1mrk)

.....  
.....  
.....  
.....

19. What is out crossing. (1mrk)

.....  
.....  
.....

**SECTION B (20 MRKS)**

*Answer ALL the questions in this section in the space provided.*

20. Study the illustration of the farm structure below and answer the questions that follow.

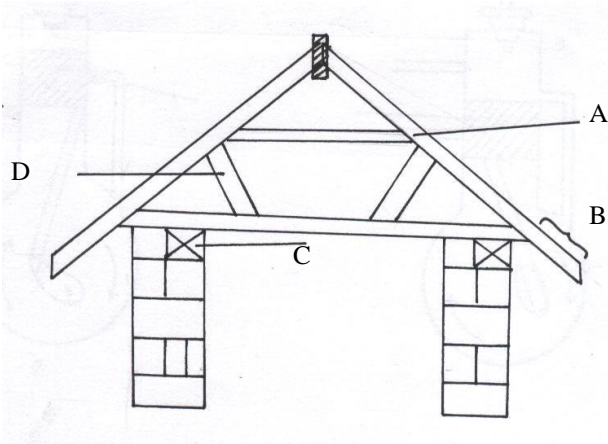

(i) Name the parts A, B, C and D. (2mrks)

- A.....
- B.....
- C.....
- D.....

(ii) State the functions of the parts A to D (2mrks)

A.....

B.....

C.....

D.....

(iii) Name two chemicals preservatives used to treat wooden parts of the structure against insect and fungal damage. (1mrk)

.....  
.....  
.....

21. Assume you have a piece of sawn timber with dimensions as shown below.

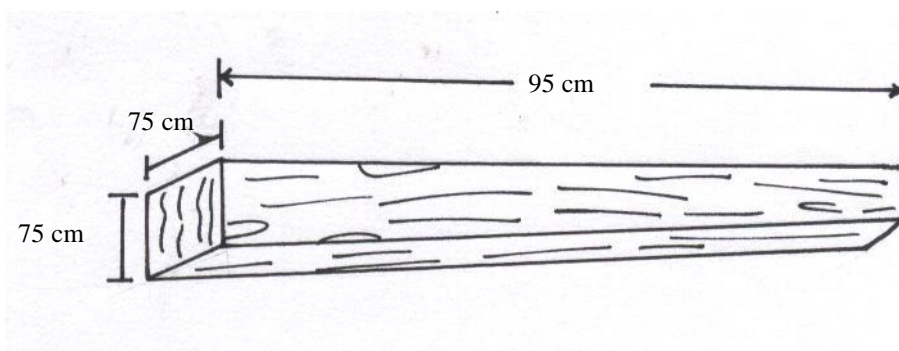

Describe how a round handle 85cm long would be prepared from the piece of timber and fixed to an axe as shown below. For each operation name the correct hand tool (s) that would be used. (5mrks)

.....  
.....  
.....  
.....  
.....  
.....  
.....  
.....  
.....

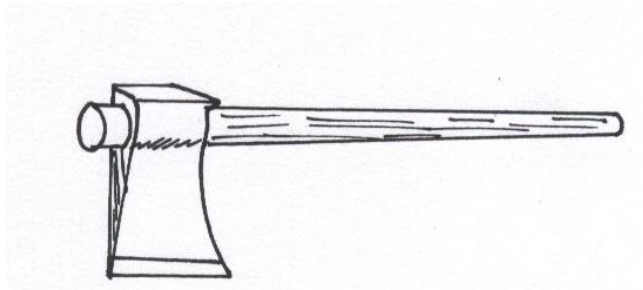

22. The diagrams below represent strokes in two stroke cycle engine. Use it to answer the questions below.

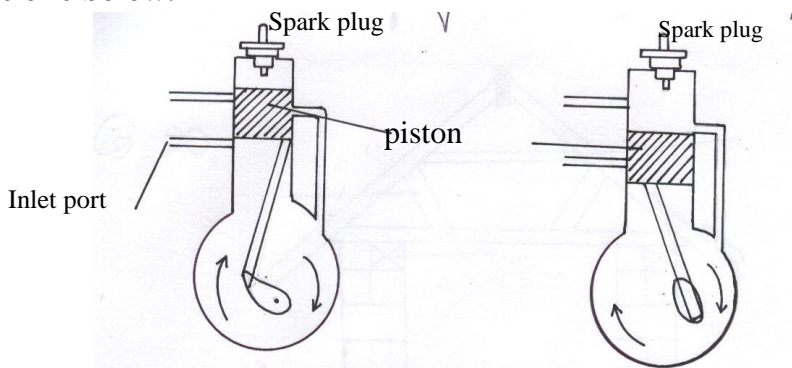

(i) Identify the strokes and explain what is happening in each stroke. (5mrks)

.....

.....

.....

.....

.....

.....

.....

.....

.....

23. Describe the procedure which should be followed to castrate a three week old piglet using surgical method.

(5mrks)

.....

.....

.....

.....

.....

.....

.....

.....

**SECTION C (40MARKS)**

*Answer any two questions in this section in the space provided after the questions.*

24. Describe the management of layers in deep litter system from day one to week 20.

(20mrks)

25. a) Discuss the structural and functional difference between petrol and diesel engine.

(10mrks)

b) Give the operational difference between disc and mould-board plough.

(5mrks)

c) Give the conditions under which a farmer would use animal power instead of tractor power in seedbed preparation.

(5mrks)

26. a) Outline the factors that should be considered when planning the layout of a mixed farm.

(10mrks)

b) Describe foot rot disease in sheep management under

(i) -Cause (1mrk)

(ii)- Symptoms (4mrks)

(iii)- Control (5mrks)

.....

.....

.....

.....

.....

.....

.....

.....

.....

.....

.....

.....

.....

.....

.....

.....

.....

.....

.....

.....

.....



Dotted lines for writing.

Dotted lines for writing



Dotted lines for writing.